

01. Stay safe

In order to enjoy a long and joyful experience with Beam there are a couple of things to keep in mind. Read the following section about safety and regulations before using Beam.

- Never leave the power cord plugged in without a Beam screwed in
- Do not unscrew Beam with the power plugged in or switched on
- Always turn Beam off manually by holding down the button for two seconds and follow the instructions on the screen before unplugging
- Disconnect the power plug by pulling the plug, not the cord

If one of the following things happen, directly unplug the power of Beam:

- You spill something onto Beam
- You exposed Beam to water or dampness
- You dropped Beam
- There is a lightning storm going on outside
- When there is smoke or a strange smell coming from Beam

Privacy information

Once connected with your network, Beam will share your local ip address with the webserver, enabling you to control Beam via the website: www.controlmybeam.com



Don't forget to read the rest of the safety instructions starting on page 7 of this manual before using Beam to prevent any potential accidents and misuse

02. Meet Beam!

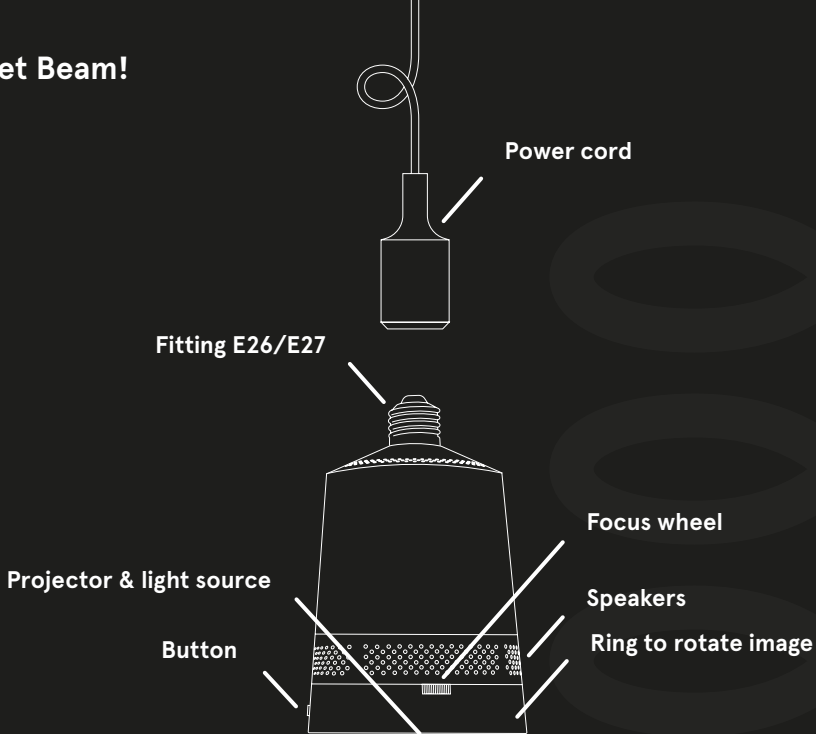

03. Let's get started

Unpacking

Have you unpacked your Beam?
If not, please do so now!

Screw it in

Screw the fitting of Beam into:

- **Any existing E26/E27 light socket.**
Make sure the light socket is switched off. Check if there is enough space in the lamp itself before screwing Beam into the socket. Beam should always have enough space to vent the warm air, so make sure that you don't fit Beam in a space that is too small without air around it.
- **Or the Beam power cord with E26/E27 socket.** Again, make sure the cord is not yet connected to the wall socket before you screw Beam in there.

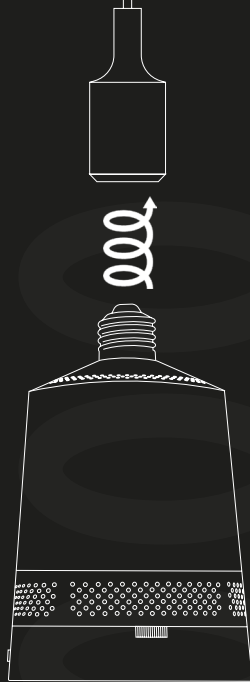

If you have any trouble with these steps you can check out our troubleshooting support here: beamlabsinc.com/faqs/setup

Get the app

Now would be a good time to download the app to be able to control Beam. Search for “Beam Remote” in the Apple App Store or in the Google Play Store to install it. If you don’t have an Apple or Android phone or tablet go to www.controlmybeam.com on a computer to set up your Beam.



Turn it on!

Exciting! If you haven’t done so yet, plug in the power cable and Beam will turn on automatically. If you screwed Beam into anything with a switch on it, then just flip the switch. There is no need to press the button on Beam to do this.

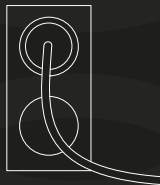

Focus the projection

In order to adjust the focus of Beam simply turn the little wheel on the front side of Beam until you have that crisp and sharp projection you were expecting.

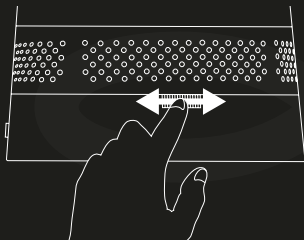

Adjust the image

By rotating the frontal ring of Beam you adjust the position of the projection. The frontal ring does not turn 360 degrees around, so be gentle with it. Use the Beam app to flip the image 180 degrees if you can't reach the angle you want.

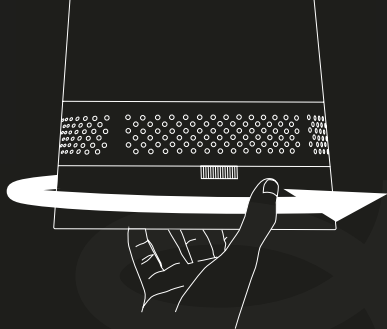

Different modes

Beam has a button to switch between the different modes. By shortly pressing the button, you switch between the standby mode, the light mode, the projection mode and then back to the standby mode. If you keep the button pressed for 2 seconds Beam will ask if you want to shut down completely.

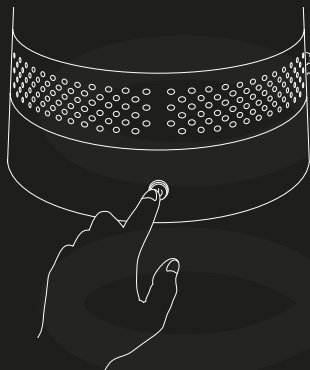

Wifi setup

Now simply follow the displayed steps for the Wifi setup and you are ready to go!

Careful with that

Beam is designed and evaluated to the latest safety standards in the field of Consumer Electronics. In order to enjoy Beam for a long time and ensure safe usage of Beam it is important that safety instructions marked on the product and in the documentation are followed.

General Safety Instructions

- Keep Beam away from all sources of liquids. Watch out with your drinks and do not place anything containing liquid near or on top of Beam such as a vase, flower pot, medicine, or anything else containing liquids. **This may result in fire or electric shock, or cause injury due to failing.**
- Don't insert anything into Beam. Especially no pieces of metal like hairpins, coins or knives, nor any flammable materials such as paper or matches. **This is to prevent electric shock or fire.**
- Never try to open any part of Beam. **There is risk of electric shock.**
- There are no user serviceable parts inside Beam.
- Do not look directly into the lens while Beam is in use (both when projecting or when functioning as a light source). **The bright light may damage your eyes.**
- In case of a gas leak in the room, do not touch Beam or the power outlet. Open the windows for ventilation. **Sparks may cause fire or burns.**
- Do not use Beam near electronic devices that generate a strong magnetic field.
- Beam is sensitive to extremely high temperature environments so please, do not place him into such a situation. **This may result in fire.**
- Don't place anything onto Beam, don't drop anything onto Beam and don't drop Beam. **This may cause damage to Beam and/or personal injury.**

- Be careful not to allow any impact to the lens, especially during transport. Do not touch the lens of the projector. **You might damage the lens.**
- In the event that no image appears on the screen or no sound is heard after 10 seconds, stop using the projector. Switch off the projector, unplug it from the power outlet and contact our support team.
- It is recommend that you maintain a distance of more than 5 to 7 times the diagonal length of the screen. **If you watch the screen at a close distance for a long time, you can damage your eyesight.**
- Do not block the light beam emitted from Beam using a book or other objects. **Lengthy exposure to the projector beam may result in fire. In addition, the lens may be overheated and damaged by the reflected heat.**
- Do not spray Beam with water when cleaning. Make sure no water flows into Beam and don't take Beam with you into the shower at any time.
- Protect Beam from dampness or wet weather. **This may result in fire or electric shock.**
- Use air spray, a soft cloth or a moistened cotton swab to remove dust or strains on Beam itself or the front projection lens
- Please, do not leave Beam powered on while unattended and within reach of children.
- When you go out, place Beam out of reach of animals, and remove the cord and power plug from the wall outlet.
- Never use a damaged power cord this may result in short circuit or fire.
- Do not use Beam near high-precision electronic devices or those that transmit weak radio signal. **This may affect the operation of the product.**
- Only a qualified technician can disassemble or modify Beam.

- For diagnosis, adjustments, or repair, contact your seller or our service center.
- Proper ventilation required, do not block airflow around Beam. Doing so can cause internal overheating and this may lead to an injury.
- To prevent damage to the lamp, Beam must remain plugged in for approximately 3 minutes after power down to allow for proper cool down.
- Do not touch the lens; doing so can result in burns or damage to the lens. The lens and Beam may be hot during and after use.
- Use caution when handling Beam, allow time for proper cool down.
- Follow all maintenance guidelines for optimal use.
- Be sure to unplug Beam if it is not to be used for a long period of time. **Accumulated dust may result in fire or electric shock due to overheating, ignition, or poor insulation.**

⚠ CAUTION!

Hazardous optical radiation may be emitted from this product. Do not stare into the lens at the operating lamp. It may be harmful to your eyes.

04. Any questions?

For questions, troubleshooting or support, visit: [beamlabsinc.com/support](https://www.beamlabsinc.com/support)

www.beamlabsinc.com
support@beamlabsinc.com

Manufacturer: Beam Labs B.V.

Model name: Beam v1.0.2

Software version: Android 4.2 with Beam Labs firmware v1.1

Power: Light socket powered E26/E27, 100V to 240V 50/60Hz

Class of equipment: Class II

Usage: Indoor use only

Dimensions: 110mm radius and 170mm height

Weight: 496 grams

HS/TARIC Code: 8528.6100.90

Pay attention.

When Beam is connected to the internet you can install apps on Beam via the Google Play Store (in the All Apps screen on Beam). Please note that when you open the Play Store for the first time, Beam will update all its apps and can be slow to respond for a few minutes depending on your internet connection!

